

Check that...

- You have correctly identified the wires.
- The connections are tight.
- No loose strands have been left out of the connection block.

Commissioning

- The ceiling surface must be flat and smooth to ensure a good fit.
- This product has two colour options: warm white or cool white. Select preferred colour before installing by using the switch on back of the product.
- Push the spring clips upwards and fit into the ceiling hole. See Fig 1.
- Push the unit up until firmly in position, ensuring that no cables are trapped. See Fig 2.
- Ensure that the product is fitted properly in the hole.
- Replace fuse or circuit breaker and switch on. Your light is now ready for use.

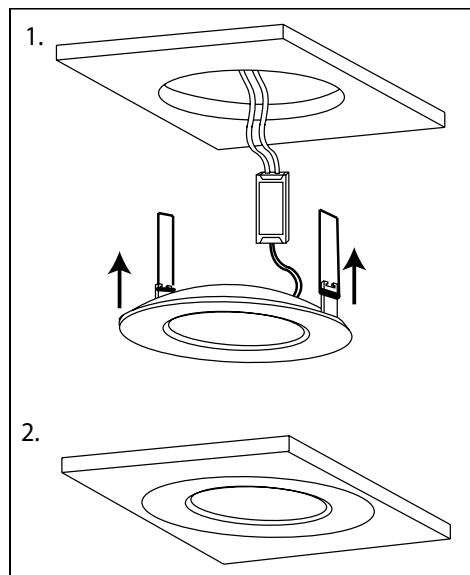

Fitting/replacing bulbs

- This product contains non replaceable parts and cannot be serviced.
- We recommend cleaning with a soft dry cloth. Do not use solvents or abrasive cleaners as these could damage the finish.

Recycling advice



Waste electrical products should not be disposed of with household waste. Please recycle where facilities exist. Check with your Local Authority or retailer for recycling advice.

Safety information

For your safety, always switch off the supply before cleaning.

Instruction leaflet

OrbitalPro Recessed

71208, 71209, 71210, (30, 60, 90 minute fire rated)
71512, 71515 (30 minute fire rated)



CE

saxby
lighting

Thank you for purchasing this light fitting. Please read the instructions carefully before use to ensure safe and satisfactory operation of this product. Please retain these instructions for future reference.

Warning

This light fitting is Double Insulated and does not require connection to an Earth circuit.

Please read these instructions carefully before commencing any work.

This unit must be fitted by a competent and qualified electrician.

Install in accordance with IEE Wiring regulations and current Building Regulations.

This system operates at Safety Extra Low Voltage, via the supplied LED driver. Never connect the light fittings directly to the mains without using the supplied LED driver.

Always disconnect the LED driver from the mains when installing or maintaining this system.

To prevent electrocution switch off at mains supply before installing or maintaining this fitting. Ensure other persons cannot restore the electrical supply without your knowledge.

This light fitting should be connected to a fused circuit.

If replacing an existing fitting, make a careful note of the connections.

This system contains non-replaceable parts and cannot be serviced. If damage occurs the part should be scrapped.

71208/71209/71210: These products are suitable for use in 30, 60 or 90 minute fire rated ceilings.

71512/71515: These products are only suitable for use in 30 minute fire rated ceilings.

Specification

Voltage:	240V 50Hz
Lamp:	71208/71209/71210: 9W LED Module: 450lm - 3000K/5000K 71512: 12W LED Module: 640lm - 3000K/5000K 71515: 15W LED Module: 920lm - 3000K/5000K
IP rating:	Front of product: IP65 Rear of product & driver: IP20

Layout

- Plan the desired layout of these fittings carefully, ensuring the cables will reach the distances between the transformer and each light fitting.
- Avoid locating any cables in positions that would cause a hazard. Position cables and junction boxes (not supplied) away from areas where they may be at risk from being cut, trapped or damaged.
- The mains supply cable must have a minimum cross sectional area of 1.0mm².
- The distance between units must be 0.5m minimum.
- The unit must be located a minimum distance of 50mm from a joist.
- This product must be mounted out of arms reach.
- This product is suitable for covering with thermal insulation.

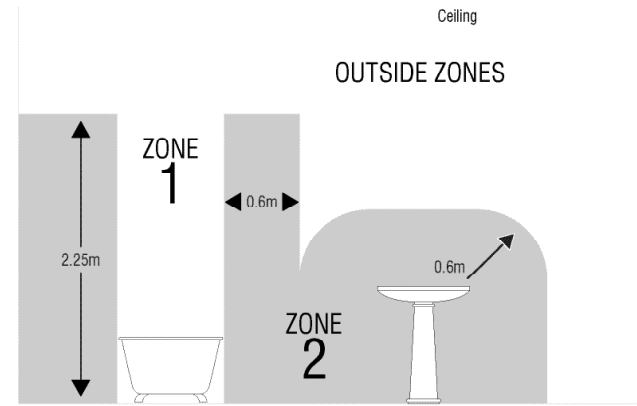

This product is suitable for use in Zone 1, Zone 2 and outside Zones of a bathroom. See diagram. If this unit is being fitted in a room containing a bath or shower, a 30mA RCD must be used, in accordance with IEE regulations.

Installation

Existing fittings must be completely removed before installation of a new product. Before removing the existing fitting, **carefully note the position of each set of wires.**

- Position the LED Driver next to the mains outlet that the system will connect to. Do not connect at this stage.
- Cut a hole in the ceiling using an appropriate tool. Cut out sizes and ceiling void depths are as follows:
 - 71208/71209/71210: 97mm diameter*/ 75mm minimum ceiling void depth
 - 71512: 125mm diameter*/ 85mm minimum ceiling void depth
 - 71515: 155mm diameter*/ 95mm minimum ceiling void depth

*Adjustable holesaw cutter may be needed to achieve correct size.

- It is recommended to cut the hole slightly smaller than needed, then file the hole until the recessed unit fits snugly.
- Wire as detailed below.

Wiring

- Unclip the cover from the quick fit connection case. Having correctly identified the wiring from your existing light fitting, pull the mains wire through the hole and connect to the connection block inside the quick fit connection case in the following way. No tools are necessary.

