

Wiring

Having correctly identified the wiring from your existing light fitting, pull the wire through the hole and connect to the connection block inside the product in the following way:

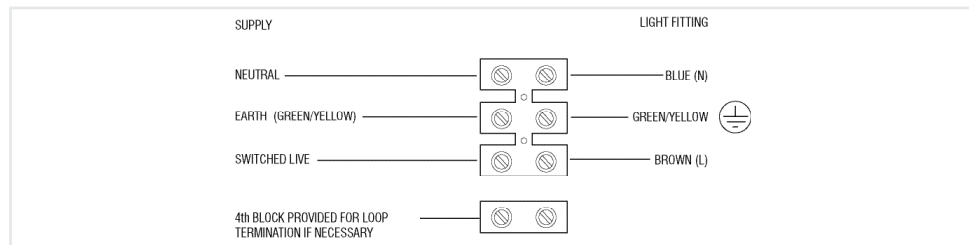

Check that...

- You have correctly identified the wires.
- The connections are tight.
- No loose strands have been left out of the connection block.
- When completed, ensure that there are no bare or loose strands of wire exposed, and cover all exposed areas of the connection block with 2 layers of insulation tape.

Care and Safety

- We recommend cleaning with a soft dry cloth. Do not use solvents or abrasive cleaners as these could damage the finish.
- Always disconnect the product from mains at least 10 minutes allowing to cool down before any maintenance or adjustment.

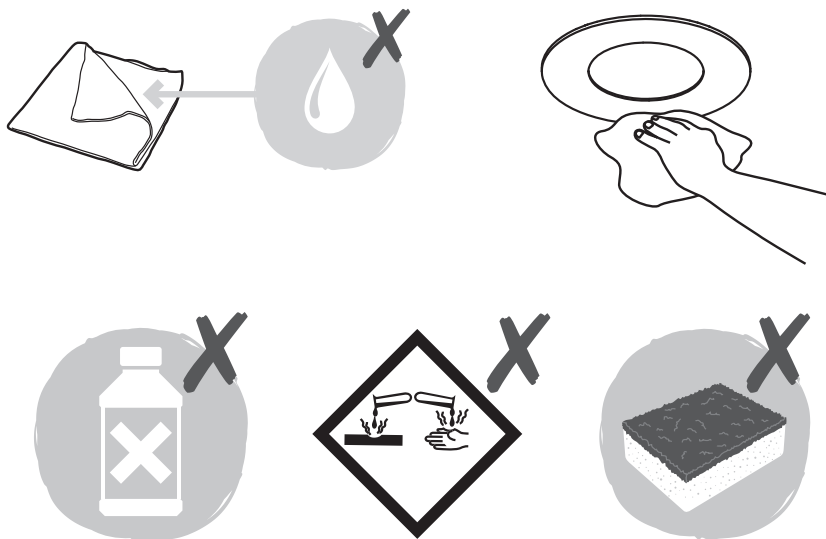

Iss .3 05/11/2018

Instruction leaflet

Commercial Downlight- Budget Recessed

78543, 78544



78543: Ø 17.4cm

78544: Ø 23.0cm



saxby
lighting

Thank you for purchasing this light fitting. Please read the instructions carefully before use to ensure safe and satisfactory operation of this product. Please retain these instructions for future reference.

Warning

Please read these instructions carefully before commencing any work.

This unit must be fitted by a competent and qualified electrician.

Install in accordance with IEE Wiring regulations and current Building Regulations.

Check the pack and make sure you have all of the parts listed.

To prevent electrocution switch off at mains supply before installing or maintaining this fitting. Ensure other persons cannot restore the electrical supply without your knowledge.

If replacing an existing fitting, make a careful note of

the connections.





This fitting must always be fitted to a plasterboard ceiling. This must not be fitted to a plaster and lath ceiling

This system contains non-replaceable parts and cannot be serviced. If damage occurs the part should be scrapped.

This product is not suitable for dimming.

Waste electrical products should not be disposed of with household waste. Please recycle where facilities exist. Check with your local authority or retailer for recycling advice.

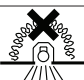
Technical data

Supply Voltage:	240 V~, 50 Hz
Bulb Type:	LED (18 W) 2835 4000K - 1800lm (78543) LED (25 W) 2835 4000K - 2500lm (78544)
	The light source of this luminaire is not replaceable; when the light source reaches its end of life the whole luminaire shall be replaced.
	Conformity with all relevant EC Directive requirements.
	Waste electrical products should not be disposed of with household waste. Please recycle where facilities exist. Check with your Local Authority or local store for recycling advice.
	Class I product, must be connected to earth.
	Luminaires not suitable for covering with thermally insulating material.
	This product is not suitable for dimming.
IP20	

Installation

- Before commencing any installation or maintenance work, ensure electricity is disconnected / isolated.
- The ceiling surface must be flat and smooth to ensure a good fit.
- Used as a Recessed light, cut a 153mm(78543)/205mm(78544) hole using an appropriate tool . See Fig 3. It is always recommended to cut the hole slightly smaller than the size specified, and then file the hole until the recessed unit fits snugly.
- Ensure that the product is sitting properly in the hole.
- Ensure that the void depth is a minimum of 65mm.
- Avoid locating any cables in positions that would cause a hazard. Position cables and junction boxes (not supplied) away from areas where they may be at risk from being cut, trapped or damaged.
- The mains supply cable must have a minimum cross sectional area of 1.0mm².
- The distance between units must be 0.5m minimum.
- This product must be mounted out of arms reach.
- There is at least 0.2mm distance between the lamp and the inflammable materials.
- Replace fuse or circuit breaker and switch on. Your light is now ready for use.

Fig 1. Make sure the power is turned off before installation

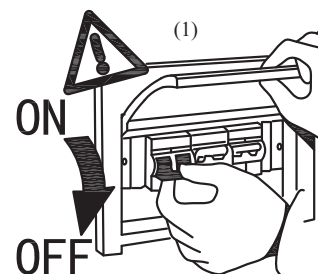

Fig 2. Unscrew the two screw on the power shell with a screwdriver until the lid of the power shell is opened

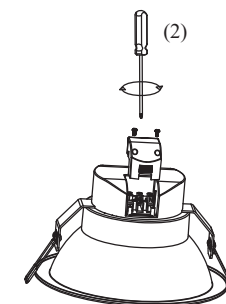

Fig 3. Open hole dimension of 205mm in ceiling installation, then access the product according to the wiring , Finally, adjust the spring on both sides until the lamp is fitted into the mounting hole

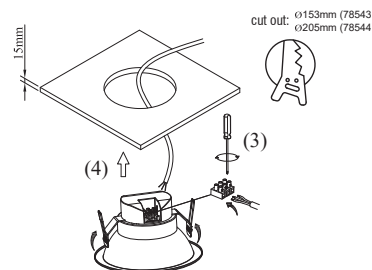

Fig 4.

